

MYSTERY

Technical Rider 2019

Page 1 of 5

MYSTERY TECHNICAL RIDER 2019

If you have any questions regarding production, please contact Michel St-Pere @ 514-297- 2246 or promotion@unicorndigital.net

Artists' crew must be allowed to operate any and all equipment provided by the Purchaser or the Purchaser's sub contractors. No other acts will be permitted to use the Artists' equipment (ie: drums, Amps) or the services of the Artists' crew without prior consent of the Artists' Tour or Production Manager. The equipment and special effects of any other acts on the same stage will be operated under the supervision or control of the Artists' Tour Manager and he/she shall have the final decision in the placement of any and all equipment on or off stage.

STAGE PLOT/ INPUT LIST

See Attached

LABOUR

When purchaser is supplying production, 2 sober, able bodied stage hands will be required for Artist back line load in, set up, tear down and load out. **Technicians:** One FOH Audio Technician/ Operator, One Monitor Technician / Operator, One Lighting Technician/ Operator. Technicians may be required to operate for the show at no cost to the Artist. **STAGING**

A sturdy, safe and well constructed stage that is a minimum of 24" wide x 20" deep x 4" high will be required with a set of stairs on each side and a ramp in the centre of the up stage side for load in and out. Stage decking should be black and skirted at the front. **RISERS**

2 – 8'x8'x1' sturdy risers will be required. 1 is for drums and 1 is for keys. Drum riser should be carpeted.

POWER

When purchaser is supplying audio and lighting production, 6x15amp, grounded, AC receptacles, on stage, are required for powering Artist's back line equipment. **FOH AUDIO** PA: V-Dosc , D&B j-series, JBL Vertec, (all depending on venue/show size) (Please advise on room size) Speaker system must be properly powered and set up by a qualified system technician.

48 Input console WITH VCA's (Midas Heritage 3000/XL4; Yamaha PM-4000; Soundcraft Series 5) Digital consoles such as the Digidesign Profile, Venue and the Yamaha PM5D-RH are acceptable. 12 x Insertable Compressors (Drawmer DL241/BSS DPR 402 or DPR 404) 8 x Gates (Drawmer DS 201)

3 x High Quality Reverbs (TC Electronic M2000/M5000/M1) 2 x Delay (TC Electronic D-2 or 2290) 1 x CD 1 x CDR

MONITORS

40- Input Monitor Console: Midas Heritage 3000/XL250. Digital consoles such as the Digidesign Profile, Venue and the Yamaha PM5D-RH are acceptable. 6 x Bi Amplified Mixes on 10 Wedges; Clair 12AM, EAW SM15, EV XW12 or XW15 3 way stereo side fill on outdoor events 8 x 1/3 Octave Graphic Eq's Inserted on mixes : Klark DN360 1 stereo mix of In Ear Monitors for lead vocal. Sennheiser or Shure with spare ear buds 4 x Drawmer DL241 Comps 6 x Drawmer DS501 Gates 1 x Microphone, DI and Stand kit to artist's spec. (see plot) **LIGHTING** Lighting System will vary with each Venue, but should, in all cases, be capable of covering the entire stage, with a minimum of 3-colours washes, plus 6 source 4 Leko's and should also include 12-16 Mac 2- K or 700 profiles moving fixtures. The lighting console should be either a Full Grand MA or MA light console. A Good hazer should be provided with a fan. Please have lighting supplier contact Artist's Lighting Director to discuss lighting plot and placement.

MYSTERY

MYSTERY Backline Requirements 2018

Keyboards :

1x Arturia Keylab 88 (or 88 Keys USB controler)
1x Arturia Keylab 49 (or 49 Keys USB controler)
1x Alesis Vortex - USB/MIDI Keytar Controller with stand

Keyboard Accessories:

1x Keyboard stand for 2 keyboards (ex: Quiklok QL-642)
1x Keyboard stand
2x Sustain pedal
1x Small table (to put Computer & Audio Interface)*

Guitars

4 x Fender Twin - or 4 High end guitar amp with effect loop send and return

Bass

1 x 300 + watt bass amp such as: Ampeg SVT, Gallien Krueger, SWR with 2 x 4x10" cabinets

Drums

Maple drumset (yamaha maple custom; mapex orion; tama starclassic; dw collector; etc...)

1 x 22" kick Drum
1 x 14"x5" Snare (chrome or wood)
1 x 14"x6" Snare (Chrome or wood)
1 x 8" Tom
1 x 10" Tom
1 x 12" Tom
1 x 14" Floor Tom (stand mounted)
1 x 16" Floor Tom (stand mounted)

Cymbals Sabian HHX series

- 16-17-18-19 crashes
- 14 hihat
- 20 ride
- 18 chinese
- 8-10 splashes

1 x hi end double bass pedal (dw9000)
1x all hardware to support drums and cymbals.
1x motorcycle drum throne with backrest

***NOTE:** All hardware must be of double braced construction (Tama or DW) Kick, Tom and Floor Tom heads should all be pin stripe heads and be in good condition Both Snares should have Ambassador coated heads and be in good condition

MISCELLANEOUS

4x Single Guitar Stands
All necessary cabling for Guitar, Bass and Keys
1 Roll of black Gaffers Tape

MYSTERY

INPUT LIST 2017

DRUMS				
INPUT	Description	Mic / DI	Stand	INSERT
1	Kick			
2	Snare Top			
3	Snare Bottom			
4	Hi-Hat			
5	Tom1			
6	Tom2			
7	Tom3			
8	Floor1			
9	Floor2			
10	OverHead Left			
11	OverHead Right			
BASS				
INPUT	Description	Mic / DI	Stand	INSERT
12	Bass DI	Direct Box		
13	Taurus Pedals DI	Direct Box		
Guitars				
INPUT	Description	Mic / DI	Stand	INSERT
14	Guitar Lead Amp Left	Mic		
15	Guitar Lead Amp Right	Mic		
16	Guitar Rythm Amp Left	Mic		
17	Guitar Rythm Amp Right	Mic		
18	Guitar Rythm accoustic	Direct Box		
KEYBOARDS				
INPUT	Description	Mic / DI	Stand	INSERT
19	Keyboard Rig Left DI	Direct Box		
20	Keyboard Rig Right DI	Direct Box		
21	Keyboard (Singer) Left DI	Direct Box		
22	Keyboard (Singer) Right DI			
VOCALS				
INPUT	Description	Mic / DI	Stand	INSERT
23	Lead Vocals	Mic		
24	Bass Vocals	Mic		
25	Rythm Guitar Vocals	Mic		
26	Drums Vocals	Mic		
27	Flute (Lead vocals center)	Mic Line only		
28				
29				

In Ear monitoring for Lead Singer, Drummer and Lead Guitar

MYSTERY

DELUSION RAIN

DRUMS CENTER SETUP

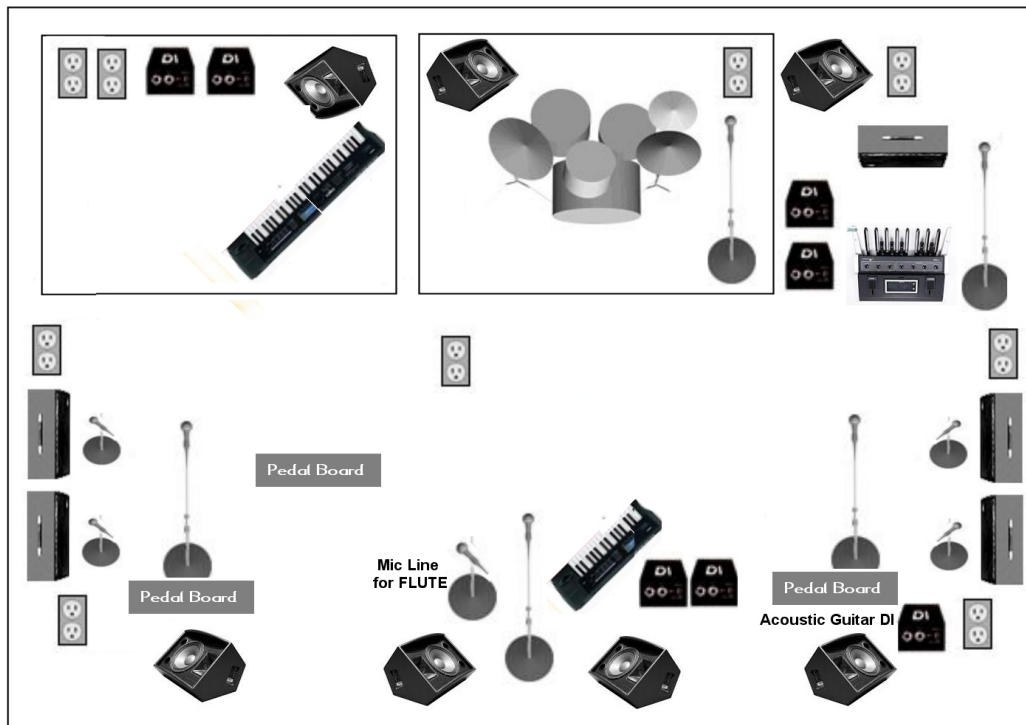

MYSTERY

DELUSION RAIN

DRUMS LEFT SETUP

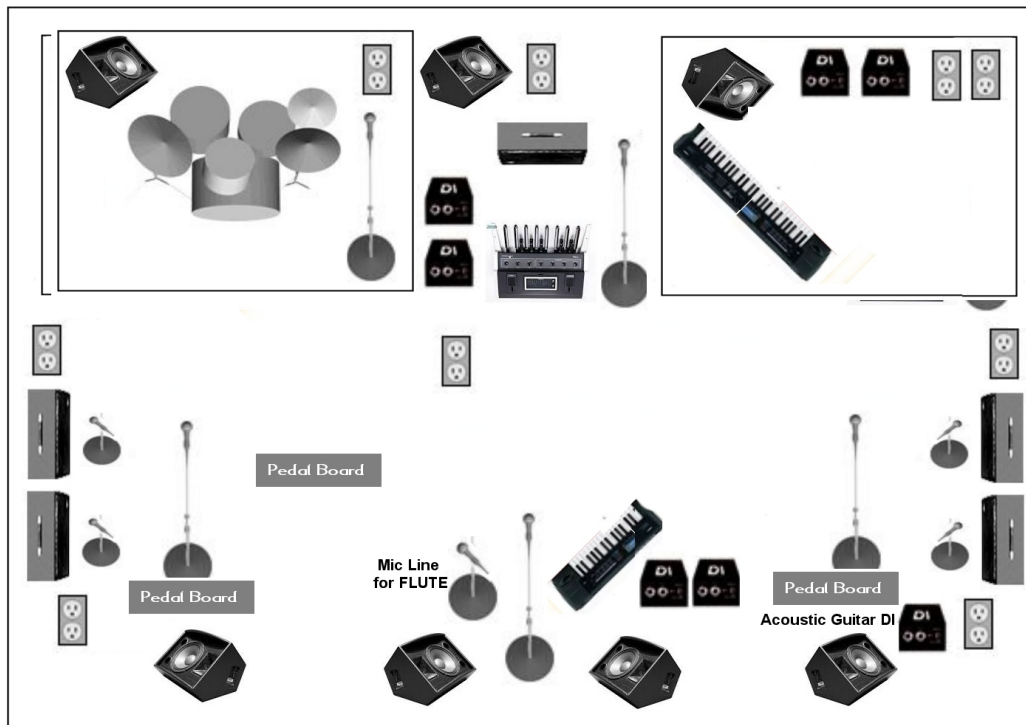

unicorn
digital

MYSTERY – Unicorn Digital Inc.

c.o : Michel St-Pere

P.O.BOX 521

BP RIVE-NORD

Boisbriand, Quebec

CANADA, J7E 4J8

514-297-2246

promotion@unicorndigital.net